

# permobil | SEATING + POSITIONING

## ROHO® Non-powered Mattress Overlays & Accessories Operation Manual



Supplier: This manual must be given to the user of this product.

Operator (Individual or Caregiver): Before using this product, read the instructions and save for future reference.

s h a p e f i t t i n g t e c h n o l o g y®



## Table of Contents

Intended Use	2
Important Safety Information	2-3
Parts Detail	4
Placing the Overlay	5-7
General Placement Instructions	
Straps for PRODIGY and SOFFLEX 2	
Insert Pad and Leveling Pad	
Overlay Enclosure Cover	
Cover Guide	
Inflating the Overlay	7
Adjusting the Overlay	8-9
Adjustment Instructions	
Pillow Positioning	
Transferring Onto the Overlay	
Troubleshooting	10
Removing the Cover and Overlay	
Cleaning and Disinfecting	11
Product Specifications	12
Disposal, Recycling and Storage	
Limited Warranty	
Español	13
Français	25
Deutsch	37
Italiano	49
Nederlands	61
Dansk	73
Svenska	85
Norsk	97
Suomi	109
Português	121



ROHO, Inc., 100 North Florida Avenue, Belleville, Illinois 62221-5429 U.S.A.

U.S.A.: 800-851-3449 • Fax: 888-551-3449 • Customer Support: [orders.roho@permobil.com](mailto:orders.roho@permobil.com)

Outside the U.S.A.: 618-277-9150 • Fax: 618-277-6518 • [intlorders.roho@permobil.com](mailto:intlorders.roho@permobil.com)  
[permobilus.com](http://permobilus.com)

Products may be covered by one or more U.S. and foreign patents and trademarks, including ROHO®, DRY FLOATATION®, PRODIGY®, SOFFLEX® and shape fitting technology®.

Product information is changed as needed; current product information is available at [permobilus.com](http://permobilus.com).

ROHO, Inc. is part of Permobil Seating and Positioning.

© 2008, 2018 Permobil

Rev. 07/16/2018

## Intended Use

The ROHO® DRY FLOATATION® Mattress Overlay System (Standard Overlay) and the ROHO DRY FLOATATION Bariatric Mattress Overlay System (Bariatric Overlay) are non-powered, air-filled, adjustable, zoned, reactive, full support surfaces that are intended to conform to an individual's shape to provide skin/soft tissue and deep tissue injury protection and an environment to facilitate wound healing. ROHO mattress overlays must be used on top of standard hospital, nursing home, home care or consumer mattresses. There is no weight limit for the Standard Overlay or Bariatric Overlay, yet they must be properly sized to the bed mattress, and areas of the individual that require skin/soft tissue protection must be supported by the Standard Overlay or Bariatric Overlay.

The ROHO® PRODIGY® Mattress Overlay System (PRODIGY) is a non-powered, air-filled, adjustable, zoned, reactive, full support surface that is intended to conform to an individual's shape to provide skin/soft tissue and deep tissue injury protection. The PRODIGY Mattress Overlay System must be used on top of a standard hospital, nursing home, home care, or consumer mattress. There is a weight limit of 300 pounds (136 kg) when properly sized to the bed mattress, and areas of the individual that require skin/soft tissue protection must be supported by PRODIGY.

The ROHO® SOFFLEX® 2 Mattress Overlay System (SOFFLEX 2) is a non-powered, air-filled, adjustable, zoned, reactive, full support surface that is intended to conform to an individual's shape to provide skin/soft tissue and deep tissue injury protection and an environment to facilitate wound healing. The SOFFLEX 2 must be used on top of a standard hospital, nursing home, home care, or consumer mattress. There is a weight limit of 330 pounds (150 kg) when properly sized to the bed mattress, and areas of the individual that require skin/soft tissue protection must be supported by SOFFLEX 2.

The ROHO® Mattress Overlay Foam Insert Pad (Insert Pad) or ROHO® Leveling Pad (Leveling Pad) may be used in place of Standard Overlay or Bariatric Overlay sections for areas that do not require skin/soft tissue protection. Consult with a clinician.

*An experienced clinician should determine whether the product is appropriate for the individual's particular equipment needs. The product's intended use statement alone should not be relied upon to make that determination.*

*The medical products featured in this document are intended to be only one part of an overall care regimen that includes all therapeutic equipment and interventions. An experienced clinician should identify this care regimen after evaluating the individual's physical needs and overall medical condition.*

*A clinician should also evaluate for visual, reading, and cognitive impairment to determine the need for caregiver assistance or the need for other assistive technology, such as large-print instructions, to ensure proper product use.*

## Important Safety Information

Before using the product, read the warnings in this manual.



### Warnings:

- The support surface products featured in this manual will function without side rails; however, side rails may be necessary for some individuals. The decision whether to use side rails should be made by the individual's clinician and/or healthcare provider. If side rails are necessary for an individual, the following points should be considered by the individual in conjunction with his/her clinician or healthcare provider to reduce the risk of falling or entrapment.
  - If it has been determined that side rails are clinically indicated for an individual, knowledgeable and properly trained caregivers should identify and minimize any risks of entrapment in side rails.
  - If it has been determined that side rails are NOT clinically indicated for an individual, knowledgeable and properly trained caregivers should identify and minimize any risks of falling out of bed.
  - Whether side rails are used or not used, knowledgeable and properly trained caregivers should assess the need for devices or aids that will reduce the risk of falling out of bed or entrapment in side rails.
- The overlay **MUST** be correctly sized to the bed mattress and to the individual.
  - If the overlay is **NOT** correctly sized to the bed mattress and the individual, the product's benefits may be reduced or eliminated, increasing risk to skin and other soft tissue.
  - If a bed mattress is too wide, the straps provided to secure an overlay to the bed mattress may not fit as intended. If straps are not used as instructed for PRODIGY and SOFFLEX 2 Overlays, the product may slip or slide, and the individual may be vulnerable to falling.
- Skin/soft tissue breakdown can occur due to a number of factors, which vary by individual. Check skin frequently, at least once a day. Redness, bruising, or darker areas (when compared to normal skin) may indicate superficial or deep tissue injury and should be addressed. If there is any discoloration to skin/soft tissue, **STOP USE** immediately. If the discoloration does not disappear within 30 minutes after disuse, immediately consult a clinician.

## Important Safety Information, continued



### Warnings, continued:

- The ROHO SOFFLEX 2 Mattress Overlay (SOFFLEX 2) and ROHO PRODIGY Mattress Overlay (PRODIGY) should not be used by infants or other individuals who are at risk of suffocation.
- **DO NOT** use a product that is underinflated or overinflated, because 1) the product benefits will be reduced or eliminated, resulting in an increased risk to skin and other soft tissue, and 2) the individual may become unstable and vulnerable to falling. Carefully follow the instructions for inflation and adjustment. If the product does not appear to be holding air, or if you are not able to inflate or deflate the product, see "Troubleshooting." Immediately contact your equipment provider, distributor, or Customer Support if the problem persists.
- The product should be set up by your equipment provider or clinician.
- While the product is in use, continue to follow all clinician recommendations for skin protection, including any schedule for regularly repositioning the individual.
- The cushioning products featured in this operation manual may introduce radiopacities and are therefore **NOT** recommended for use with x-rays. Radiopacities may interfere with diagnoses or surgical procedures that require radiographic images.
- **DO NOT** use the handles on the ROHO Mattress Overlay Enclosure Cover (Overlay Enclosure Cover) to lift or slide the individual, as it may result in injury.
- **DO NOT** use the product as a water flotation device (e.g., a Life Preserver). It will **NOT** support you in water.
- **DO NOT** expose the product to high heat, open flames or hot ashes. Testing or certification claims, including for flammability, may no longer apply to this device when it is combined with other products or materials. Check testing and certification claims for all products used in combination with this device.
- If you are unable to perform any tasks described in this manual, seek assistance by contacting your clinician, equipment provider, distributor, or Customer Support.
- **DO NOT** use the product as a transfer surface. **DO NOT** reposition the product while it is in use.
- The cushion surface will acclimate to the surrounding temperature. Take appropriate precautions, especially when the cushion will contact unprotected skin.



### Cautions:

- Periodically, check the cover and components for damage and replace if necessary.
- Using a pump, cover or repair kit other than those compatible with your product may void your product's warranty.
- Changes in altitude may require adjustment to your product.
- Keep the product away from sharp objects.
- If a product has been in temperatures less than 32°F / 0°C and exhibits unusual stiffness, allow the product to warm to room temperature, then open air valve(s). Roll and unroll the product until the material is soft and pliable again. Repeat adjustment instructions before using.
- **DO NOT** use any valve or air cell as a handle for carrying or pulling the product. Grasp the product by the base or the outside edges.
- **DO NOT** allow your product to come into contact with oil-based lotions or lanolin. They may degrade the material.
- Prolonged exposure to ozone may degrade the materials used in a neoprene product, affect the performance of the product, and void the product warranty.



### Important Notes:

- An unoccupied product may appear to be underinflated (not enough air) even if it has been inflated and correctly adjusted for a specific individual. This is because the individual's body mass is not pushing down on the air cells.
- CPR may be performed without deflating the product. A cardiac board is not necessary.

## Parts Detail

### Package contents:

Mattress Overlay Sections and Systems include a dual action hand pump, repair kit, operation manual, limited warranty supplement and product registration card.

Mattress Overlay Systems, which include multiple sections that snap together, may also include a Reusable Overlay Cover or Overlay Enclosure Cover.

The PRODIGY and SOFFLEX 2 Overlay Systems include Straps.

Insert Pads and Leveling Pads (not shown on this page) are also available.

To order replacement parts, contact your equipment provider or Customer Support.

### Standard Overlay System with Overlay Enclosure Cover

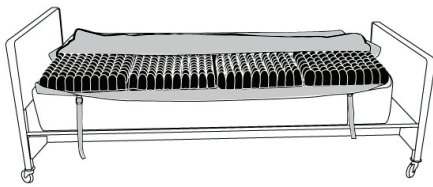

*Note: Mattress overlay systems (including PRODIGY and SOFFLEX 2) may be used with the Overlay Enclosure Cover or the Reusable Overlay Cover.*

### Standard Overlay Section

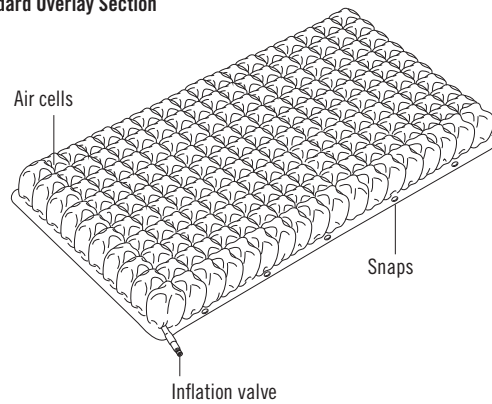

### PRODIGY Section

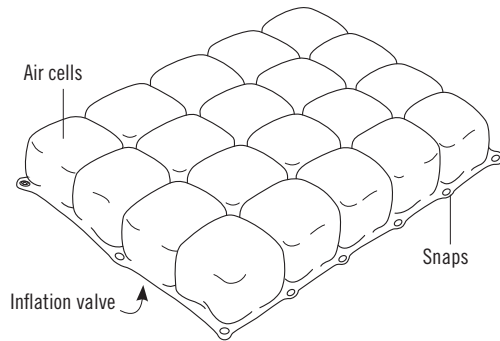

### SOFFLEX 2 Section

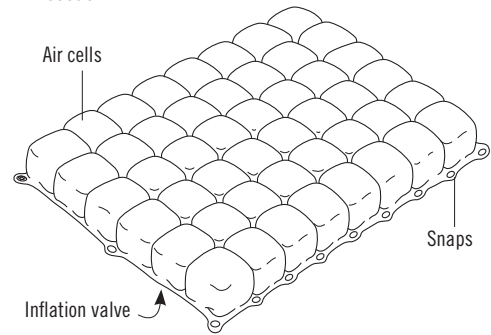

*Note: An inflation valve is located on the bottom of each PRODIGY and SOFFLEX 2 section.*



Repair Kit

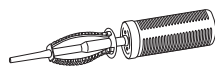

Hand Pump (Dual Action)

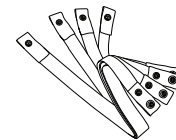

Straps for PRODIGY and SOFFLEX 2

## Placing the Overlay

### General Placement Instructions



**Warnings:**

- Risk of falling. The PRODIGY and SOFFLEX 2 overlays **MUST** be secured to the bed mattress, either with the provided straps or with the Overlay Enclosure Cover straps.
- Risk of falling: Any overlay section or system **MUST NOT** hang over the edges of the bed mattress.

- 1) Remove all bed linens from the bed mattress. A support pad or a fitted sheet may remain on the bed mattress.
- 2) Make sure the bed mattress is in a flat position.

**STOP HERE if you are using the two-piece, zipped Overlay Enclosure Cover. See the instructions for the Overlay Enclosure Cover provided in this manual. If you are NOT using the Overlay Enclosure Cover, continue with the instructions on this page.**

- 3) Place the overlay sections on the bed mattress, cells facing up.
- 4) Align the overlay sections and snap them together.
  - If you are using Insert Pads or Leveling Pads: Refer to the instructions in this manual for attachment.
  - If you are using Bariatric Overlay sections: Align and attach the Bariatric sections to the Standard Overlay sections, as prescribed.
- 5) PRODIGY and SOFFLEX 2 must be secured to the bed mattress. If you are not using the Overlay Enclosure Cover, follow the instructions below to use the straps provided with PRODIGY and SOFFLEX 2.
- 6) Continue with the instructions provided in this manual for inflating, covering and adjusting the overlay.

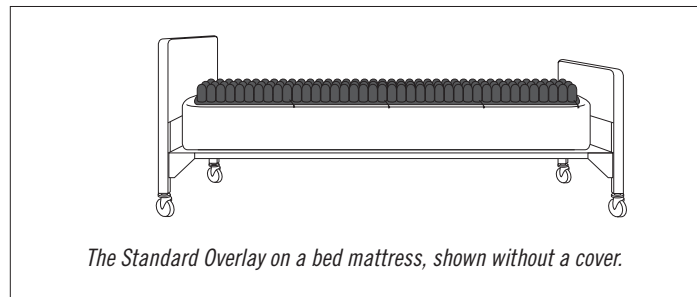
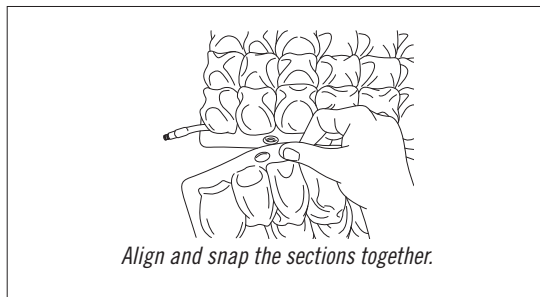

### Straps for PRODIGY and SOFFLEX 2



**Warnings:**

- Risk of falling. The PRODIGY and SOFFLEX 2 overlays **MUST** be securely attached to the bed mattress.
- Before the individual transfers onto the overlay, make sure the straps are securely snapped to the overlay.

*Note: If you are using the Overlay Enclosure Cover, you will not use these straps. See the instructions for the Overlay Enclosure Cover in this manual.*

- 1) Use a strap on each corner of the PRODIGY or SOFFLEX 2 Overlay System. Attach both ends of the strap to the snaps on the overlay, as shown.
- 2) Stretch a strap around each corner of the bed mattress.
- 3) Continue with the instructions for inflating the overlay in this manual.

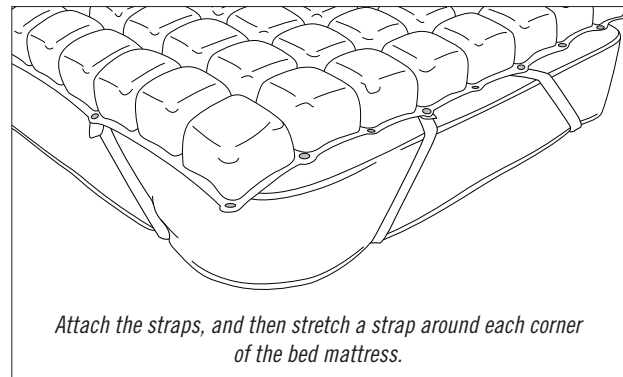

## Placing the Overlay, Continued

### Insert Pad and Leveling Pad

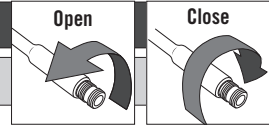

#### Warnings:

- If an individual is at risk of skin/soft tissue breakdown, **DO NOT** use Insert Pads or Leveling Pads to replace overlay sections.
- At the first indication of tissue trauma, Insert Pads or Leveling Pads **MUST** be replaced with Standard Overlay section(s).
- Make sure that the Leveling Pad(s) and Standard Overlay Sections(s) are snapped together when the individual is on the product. If the sections are not snapped together, the individual could be exposed to areas that do not provide sufficient skin protection.

#### Leveling Pad Placement

- 1) Place the Standard Overlay into the open area of the Leveling Pad as prescribed.
- 2) Continue with "Inflating the Overlay" in this manual.

#### Insert Pad Placement

- 1) Align and attach Insert Pad section(s) to Standard Overlay sections as prescribed.
- 2) Continue with the "Inflating the Overlay" instructions in this manual.

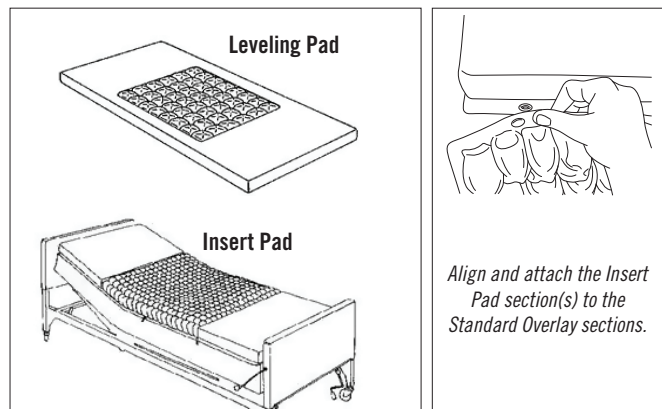

## Overlay Enclosure Cover



**Warning: Risk of falling: The PRODIGY and SOFFLEX 2 overlays MUST be secured to the bed mattress, either with the provided straps or with the straps on the Overlay Enclosure Cover.**

- 1) Place the Overlay Enclosure Cover on the bed mattress. Refer to the labels on the cover for correct orientation.
- 2) Unzip and remove or fold back the top part of the cover.
- 3) Place the overlay sections onto the bottom part of the Overlay Enclosure Cover, cells facing up.
- 4) Align the overlay sections and snap them together. If you are using Insert Pads or Leveling Pads, refer to the instructions in this manual for attachment.
- 5) For the Standard Overlay: There are two inflation valves for each overlay section. Close all valves on one side of the overlay.
- 6) Place the top part of the cover over the overlay. Leave the cover at least partially open. You will need to access the inflation valves on one side of the cover. *Note: Do not zip the Overlay Enclosure Cover closed until adjustment is complete.*
- 7) Wrap the straps under the bed mattress and secure the buckles.
- 8) Follow the instructions in this manual to inflate and adjust the overlay.

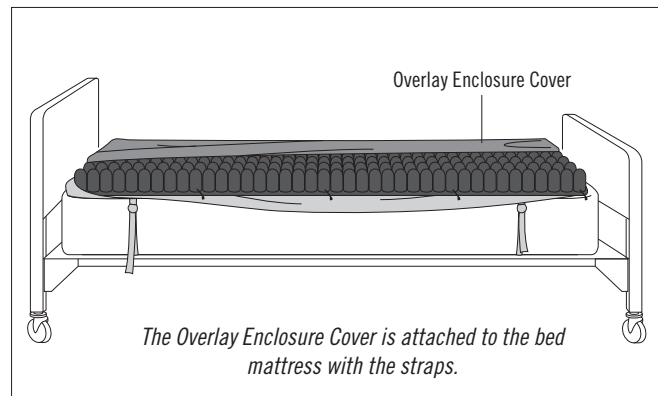



## Placing the Overlay, Continued

### Cover Guide

**!** **Warning:** Placing too many linens between the individual and the product will reduce its effectiveness.

#### To cover the overlay:

Before the individual transfers to the bed, cover the overlay. Follow these guidelines.

- Use no more than one flat or contoured sheet, arranged loosely over the mattress overlay.
- Use one incontinent pad, if needed.
- Use one draw sheet for moving and transferring, if needed.

#### ROHO Cover Options:

- One-piece Reusable Overlay Cover with elastic: Refer to the directional labels on the cover to orient and place the cover around the overlay and the bed mattress.
- Two-piece, zipped Overlay Enclosure Cover with straps: See the instructions in this manual for the Overlay Enclosure Cover.

## Inflating the Overlay

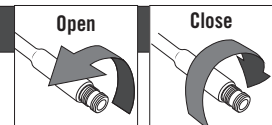

**!** **Warning:** All sections of the product, including any bariatric (side) sections, **MUST** be inflated and adjusted to ensure proper immersion and to provide skin/soft tissue protection to the individual, including their areas of risk (for example, head, shoulder blades, tailbone, hip bones, heels).

#### Notes:

- If an overlay section has more than one valve, only one of the valves should be open during inflation.
- The *PRODIGY* and *SOFFLEX 2* inflation valves are located on the bottom of each section.

- 1) Slide the rubber nozzle of the hand pump over the inflation valve.
- 2) Pinch the nozzle of the hand pump, and open the inflation valve.
- 3) Add air until all of the air cells are inflated and the overlay section arches slightly.
- 4) Pinch the nozzle of the hand pump, and close the inflation valve completely.
- 5) Remove the hand pump.

- 6) **!** **IMPORTANT!** Follow the instructions to adjust the overlay.

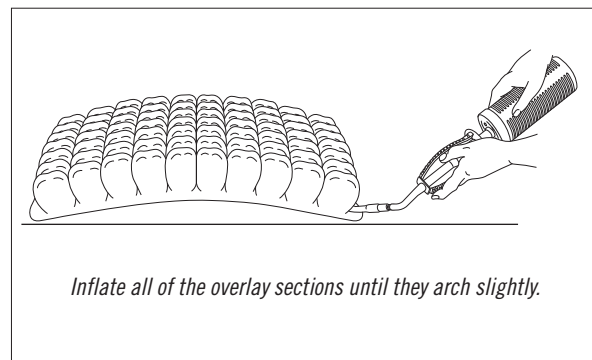

## Adjusting the Overlay

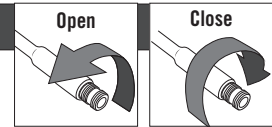

### Warnings:

- **DO NOT** use a product that is underinflated or overinflated, because 1) the product benefits will be reduced or eliminated, resulting in an increased risk to skin and other soft tissue, and 2) the individual may become unstable and vulnerable to falling. Carefully follow the instructions for inflation and adjustment.
- All sections of the product **MUST** be aligned and snapped together before the individual transfers onto the product. If the sections are not snapped together, the individual could be exposed to areas that do not provide sufficient skin/soft tissue protection.
- All sections of the product, including any bariatric (side) sections, **MUST** be inflated and adjusted to ensure proper immersion and to provide skin/soft tissue protection to the individual, including their areas of risk (for example, head, shoulder blades, tailbone, hip bones, heels).
- Check inflation and adjustment the first time and every time the individual transfers onto the product. A Hand Check **MUST** be performed **EVERY TIME** the individual transfers onto the product. If the individual transfers off and then back onto the product, a Hand Check **MUST** be performed to ensure the product is correctly adjusted and will continue to provide protection.
- Check inflation and adjustment frequently, at least once a day.

### Adjustment Instructions:

- 1) Before you adjust the overlay, make sure the overlay is properly inflated, positioned, and covered:
  - a) Follow the instructions in this manual to inflate all overlay sections, including any bariatric sections.
  - b) Make sure that the overlay and bed mattress are in a flat position.
  - c) Make sure that all sections are aligned and snapped together and that the overlay is covered.
- 2) The individual should transfer onto the overlay. The individual should be in their usual position (lying on their back, their side, or other usual position).
- 3) Adjust for proper immersion of each overlay section. Use the Hand Check Method:
  - a) Position your hand between the overlay and the individual and feel for the lowest bony prominence.
  - b) Keeping your hand in place, open the inflation valve, and remove air until you can barely move your fingertips. Refer to the "Distance from Base" table on this page to determine the recommended distance between the lowest bony prominence and the base of the product.
  - c) Close the inflation valve.
- 4) If you are using the Overlay Enclosure Cover, zip the cover closed.

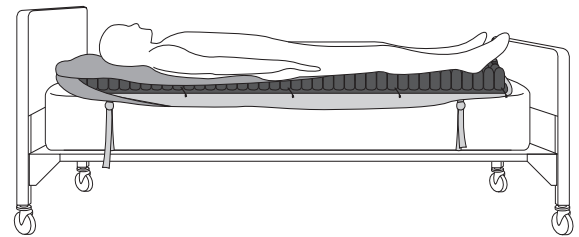

*The overlay and the bed mattress should be in a flat position during adjustment. Shown with the Overlay Enclosure Cover.*

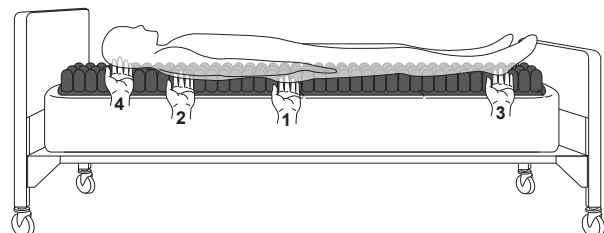

*Hand Check Method (shown without a cover): The numbers on the "hands" show a sequence for adjusting the overlay sections. This is only a suggestion. The adjustment sequence may vary for each individual.*

Distance from Base	
Standard / Bariatric Overlay SOFFLEX 2	½ in. - 1 in. (1.5 cm to 2.5 cm)
PRODIGY	1 in. - 1½ in. (2.5 cm to 4 cm)

## Adjusting the Overlay, continued

### Pillow Positioning

**Warning:** **DO NOT** place a pillow between the individual and the overlay. Doing so will reduce the effectiveness of the overlay.

Pillow positioning may be prescribed by a clinician. If a pillow is used for positioning, the pillow must be placed under the mattress overlay, not between the individual and the overlay.

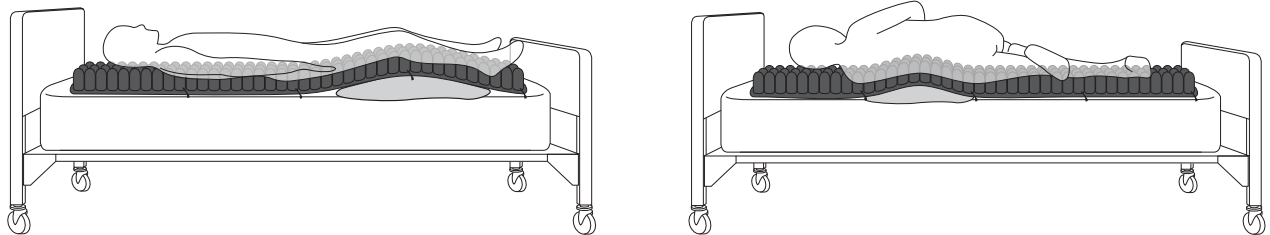

*Examples of positioning with a pillow. As shown, the pillow is placed under the overlay, not between the individual and the overlay.*

### Transferring Onto the Overlay

If the individual transfers off the overlay, follow these instructions to ensure correct adjustment:

- 1) Before the individual transfers back onto the overlay:
  - a) Make sure the sections are snapped together and lying flat.
  - b) For PRODIGY or SOFFLEX 2, make sure the overlay is securely attached to the bed mattress, either with the straps or with the Overlay Enclosure Cover straps. Follow the instructions in this manual to install the straps or the Overlay Enclosure Cover.
- 2) Make sure the overlay is inflated and covered. Refer to the instructions in this manual.
- 3) The individual should transfer onto the overlay.
- 4) Perform a Hand Check to make sure the overlay is properly adjusted. Refer to the adjustment instructions in this manual.

## Troubleshooting

**For additional assistance, contact your equipment provider, distributor, or Customer Support.**

Not Holding Air	Inflate the product. Confirm that the inflation valve is completely closed. Inspect the inflation valve(s) and hose(s) for damage. Look for holes in the product. <ul style="list-style-type: none"> <li>- If very small holes or no holes are visible, follow the instructions in the Repair Kit provided with your product.</li> <li>- For inflation valve or hose damage, or for large holes or leaks in the product, see the Limited Warranty supplement, or contact Customer Support.</li> </ul>
Not Able To Inflate or Deflate the Cushion	<ul style="list-style-type: none"> <li>- Make sure the inflation valve is open.</li> <li>- Inspect the inflation valve(s) and hose(s) for damage.</li> </ul>
Uncomfortable or Unstable	<ul style="list-style-type: none"> <li>- Make sure the product is not underinflated or overinflated. Refer to adjustment instructions for the product in this manual.</li> <li>- Make sure the air cells are facing the individual.</li> <li>- Make sure the product is the correct size for the individual and the bed.</li> <li>- Allow the individual at least one hour to adjust to the product.</li> </ul>
The Product Slides on the Bed	<ul style="list-style-type: none"> <li>- Make sure that any sections are snapped together.</li> <li>- Make sure the product is not on a slippery surface.</li> <li>- If you are using the Overlay Enclosure Cover: Make sure the straps are securely attached to the bed mattress.</li> <li>- If you are using the PRODIGY or SOFFLEX 2 without the Overlay Enclosure Cover: Make sure you use the provided straps to securely attach the overlay to the bed mattress.</li> </ul>
Product Appears To Be Uninflated	An unoccupied product may appear to be underinflated (not enough air) even if it has been inflated and correctly adjusted for a specific individual. This is because the individual's body mass is not pushing down on the air cells.

## Removing the Cover and Overlay

### To remove the Overlay Enclosure Cover and overlay TOGETHER:

- 1) The individual should transfer to a different surface.
- 2) Do not unzip the cover. The overlay should stay inside the cover.
- 3) Unbuckle the straps and remove the cover and overlay from the bed mattress.

### To remove the Overlay Enclosure Cover and overlay SEPARATELY:

- 1) The individual should transfer to a different surface.
- 2) Unzip one side of the cover and fold the top of the cover to one side.
- 3) Unsnap and remove the overlay sections from the cover.
- 4) Unbuckle the straps and remove the cover from the bed mattress.



**To remove the Reusable Overlay Cover:** The individual should transfer to a different surface. Pull each corner away from the bed mattress and overlay.

## Cleaning and Disinfecting

### Warnings:

- Inspect the product for damage and replace if necessary.
- Cleaning and disinfecting are separate processes. Cleaning must precede disinfection. Before use by a different individual: clean, disinfect, and check the product for proper functioning.
- Follow all manufacturer bleach container and germicidal disinfectant safety guidelines.
- Note about sterilization: High temperatures accelerate aging and will damage the product assembly. The products featured in this manual are not packaged in a sterile condition, nor are they intended or required to be sterilized prior to use. If institution protocol demands sterilization: First, follow the cleaning and disinfecting instructions; then, open the inflation valve and use the lowest possible sterilizing temperature, but not to exceed 70°C (158°F), for the shortest time possible. DO NOT autoclave.

### Covers

**To Clean the Reusable Cover and the Overlay Enclosure Cover:** Remove the cover from the overlay. Machine wash in cold water (30°C) with mild detergent, gentle cycle, or wipe clean with neutral detergent and warm water. Tumble dry low.  

  Caution: DO NOT dry clean the Reusable Overlay Cover.

**To Disinfect the Reusable Cover and the Overlay Enclosure Cover:** Hand wash, using 1 part household liquid bleach per 9 parts water. Keep the product wet with the bleach solution for 10 minutes. Quaternary-type disinfectants may also be used in concentrations recommended by the manufacturer. Rinse the product thoroughly. Or machine wash in hot water (60°C). (Note: Repeated washing at high temperatures can accelerate deterioration of the cover and is not recommended). Tumble dry low.



### Overlay Products

 Inspect the overlay for damage and replace if necessary.

 **Overlay Care Cautions:** Valve(s) must be closed. DO NOT allow water or cleaning solution to enter the product. DO NOT machine wash or sanitize the cushion or machine dry overlay products. Use of the following may cause damage to the cushion: abrasives (steel wool, scouring pads); caustic, automatic dishwasher detergents; cleaning products that contain petroleum or organic solvents, including acetone, toluene, Methyl Ethyl Ketone (MEK), naphtha, dry cleaning fluid, adhesive remover; oil-based lotions, lanolin, or phenolic-based disinfectants; ozone gas; ultraviolet light cleaning methods.

**To Clean the Overlay:** Remove all linens and straps. Close valve(s) and place the overlay in a large sink. Hand wash, using mild liquid hand soap, hand dishwashing liquid, laundry detergent, or a multipurpose detergent (Follow the product label instructions.) Gently scrub all product surfaces, using a soft plastic bristle brush, a sponge or a cloth. Rinse with clean water. Air dry. DO NOT expose to direct sunlight.



**To Disinfect the Overlay:** Repeat the cleaning instructions, using 1 part household liquid bleach per 9 parts water. Keep the product wet with the bleach solution for 10 minutes. Rinse thoroughly with clean water. Air dry.



### Insert pad or Leveling Pad

**Cover care:** Remove the foam pad before cleaning or disinfecting the cover. Do not immerse the foam in liquid.

**To clean the Cover for the Insert Pad or Leveling Pad:** Wipe clean with neutral detergent and water. Rinse thoroughly. Air dry.



**To disinfect the Cover for the Insert Pad or Leveling Pad:** Wipe with 1 part household liquid bleach per 9 parts water. Keep the product wet with the bleach solution for 10 minutes. Quaternary-type disinfectants may also be used in concentrations recommended by the manufacturer. Rinse thoroughly. Air dry.



**To clean the Insert Pad or Leveling Pad:** Remove the cover. Wipe gently with a cloth dampened in water and a household detergent. Rinse the cloth and re-wipe. Allow the foam to air dry thoroughly before putting the cover back on.



 Disinfectants are not effective on porous surfaces such as foam. If the foam becomes soiled or contaminated, DO NOT use with multiple individuals. Replace soiled or contaminated foam components.

 = "Wipe with a damp cloth."

## Product Specifications

### Materials:

ROHO® DRY FLOATATION® products: neoprene rubber; nickel plated brass valve(s)

PRODIGY: Flame-retardant polyvinyl chloride (PVC) film (made without DEHP); nickel plated brass valve(s); polyester/spandex straps

SOFFLEX 2: polyether polyurethane; nickel plated brass valve(s); polyester/spandex straps

ROHO® Reusable Mattress Overlay System Cover (Reusable Overlay Cover) and ROHO Mattress Overlay Enclosure Cover (Overlay Enclosure Cover): two-way stretch, moisture-resistant fabric with a zipper, straps and carrying handle. Refer to the care label attached to your cover for material content and for compliance to flammability requirements.

Sizing Table				
Product	Width x Length x Height (in.)	Width x Length x Height (cm)	Weight (lb.)	Weight (kg)
Standard Overlay Section	33.75 x 19.25 x 3.25	86 x 49 x 8.5	8.0	3.6
Standard Overlay System (4 Sections)	33.75 x 75 x 3.25	86 x 190.5 x 8.5	32.0	14.4
Bariatric Overlay System (8 Sections)	39.5 x 75 x 3.25	100.5 x 190.5 x 8.5	36.5	16.5
	41.5 x 75 x 3.25	105.5 x 190.5 x 8.5	38.5	17.4
	54.5 x 75 x 3.25	138.5 x 190.5 x 8.5	47.5	21.5
	60 x 75 x 3.25	152.5 x 190.5 x 8.5	50.5	22.9
Bariatric Overlay System (12 Sections)	48.5 x 75 x 3.25	123 x 190.5 x 8.5	45.0	20.4
PRODIGY Section	36 x 27.5 x 3.5	91.5 x 70 x 9	3.25	1.4
PRODIGY System (3 Sections)	36 x 81.75 x 3.5	91.5 x 207.5 x 9	9.6	4.3
SOFFLEX 2 Section	36 x 27.5 x 3.5	91.5 x 70 x 9	2.25	1.0
SOFFLEX 2 System (3 Sections)	36 x 81.75 x 3.5	91.5 x 207.5 x 9	6.5	2.9

Product expected lifetime: 5 years

*Note: All measurements are approximate.*

*Note: The Reusable Overlay Cover and the Overlay Enclosure Cover are designed to fit the DRY FLOATATION overlay, PRODIGY and SOFFLEX 2. Covers are not available in all sizes.*

## Disposal, Recycling and Storage

**Disposal:** The components of the products in this manual are associated with no known environmental hazards when properly used and when disposed of in accordance with all local/regional regulations. Incineration must be performed by a qualified, licensed waste management facility.

**Recycling:** Contact a local recycling agency to determine recycling options for the product. For more recycling information, contact Customer Support.

**Storage:** Clean and disinfect the product before storing. Open the inflation valve(s). Deflate the product (detach any product sections). Store the product in a container that protects the product from moisture, contaminants and damage.

## Limited Warranty

**Limited Warranty Term** from the date the product was originally purchased: DRY FLOATATION Standard Overlay and Bariatric Overlay: 24 months; SOFFLEX 2: 18 months; PRODIGY: 12 months. The warranty does not apply to punctures, tears, burns, or misuse, nor does it apply to the removable cover. See also the Limited Warranty supplement provided with your product, or contact Customer Support.



# permobil | SEATING + POSITIONING

**Mailing/Shipping Address:**

1501 South 74th Street, Belleville, IL 62223-5900, USA

**Administrative Offices:**

100 North Florida Avenue, Belleville, IL 62221-5429, USA

U.S.: 1-800-851-3449 Fax 1-888-551-3449

Outside U.S.: 1-618-277-9150 Fax 1-618-277-6518

permobilus.com



**Intertek**

The products featured in this document were  
manufactured under a Quality Management System  
that is certified to ISO 13485:2016.



MDSS GmbH  
Schiffgraben 41  
30175 Hannover, Germany

